

**ALLDAY
& MILLER**



Townsend Road, Southall, UB1 1HE
£540,000

4 2 2 C



Townsend Road, Southall, UB1 1HE

£540,000

- Four Bedrooms
- Freehold
- Walking Distance To Southall Broadway
- Air Conditioning Units
- Two Bathrooms
- New Triple Glazed Windows
- Great Transport Links
- Close To A Elizabeth Line Station

Description

A well presented four bedroom, two bathroom spacious family home situated on a popular residential street.

Brought to the market this spacious accommodation comprises of a welcoming entrance porch, an open plan reception/ dining room , modern fitted kitchen, utility room with plenty of storage space and newly fitted downstairs shower room suite with WC.

The first floor enjoys three bedrooms and a family bathroom.

Rising to the second floor boasts a double bedroom with eaves.

The front of the property with a patio space leading to the entrance door. To the rear a private garden perfect for outside dining and a large outbuilding.

Situation

Townsend Road a popular residential road in the heart of Southall with the high street being an 5 minute walk away with its variety of local shops, restaurants, cafes and coffee shops. Southall Station being moments away with the Elizabeth line providing easy links to central London. Along with the bus station with routes including H32,105, 195 and 120 to local amenities. For the motorist the M4 and M25 being within a close proximity. Highly regarded schools in the local area including Beaconsfield School and Hambrough Primary School.



Floor Plans

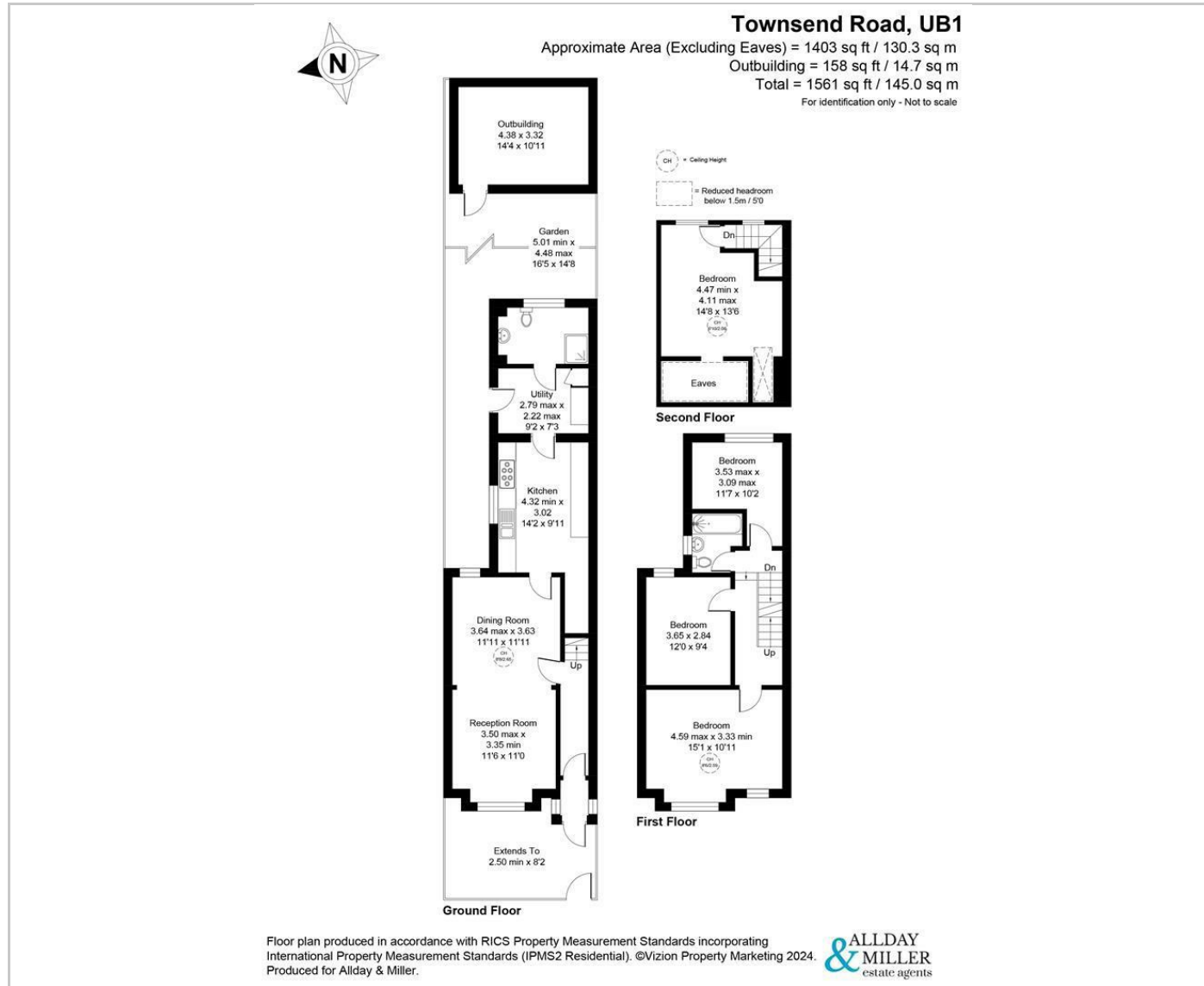

Area Map

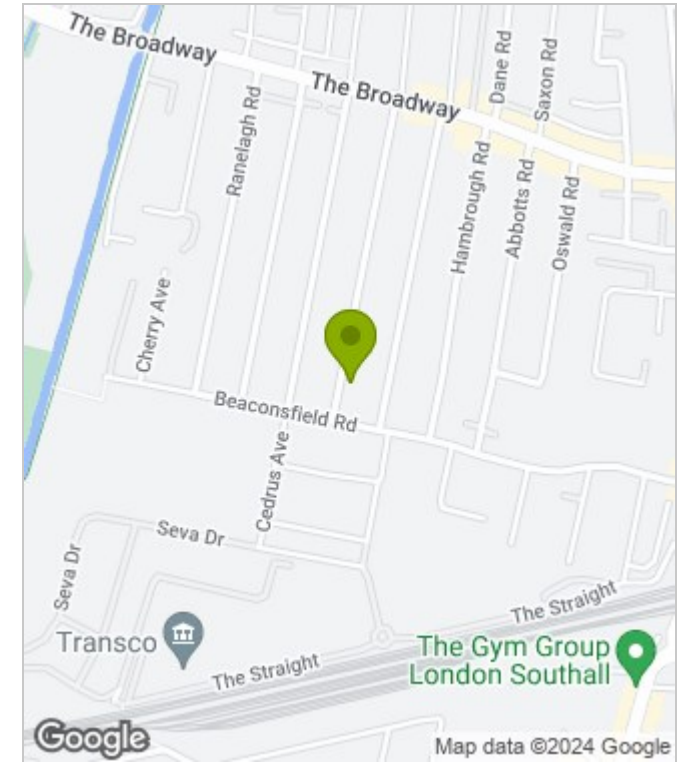

Energy Performance Graph

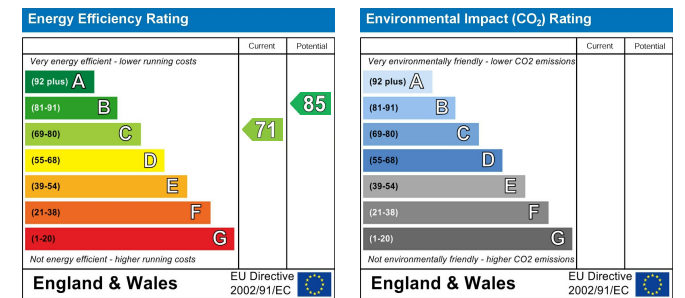

These particulars, whilst believed to be accurate are set out as a general outline only for guidance and do not constitute any part of an offer or contract. Intending purchasers should not rely on them as statements of representation of fact, but must satisfy themselves by inspection or otherwise as to their accuracy. No person in this firm's employment has the authority to make or give any representation or warranty in respect of the property.